

GEORGE W. WATSON III

One Financial Plaza, Suite 1430
Providence, RI 02903-2485
Main (401) 709-3300
Fax (401) 709-3378
gwatson@rc.com
Direct (401) 709-3351

Also admitted in Massachusetts
and Connecticut

April 20, 2015

Todd Bianco
Siting Board Coordinator
Energy Facility Siting Board
89 Jefferson Boulevard
Warwick, RI 02888

**Re: In re: The Narragansett Electric Company d/b/a National Grid
Notice of Intent to Construct a Loop Line of Less Than 1,000 Feet
(Kilvert Street Substation Loop Line)**

Dear Todd:

I am enclosing for filing an original and ten (10) copies of the Notice of Intent pursuant to Rule 1.6(c) of the EFSB Rules of Practice and Procedure on behalf of The Narragansett Electric Company d/b/a National Grid for the Kilvert Street Substation in Warwick.

Please acknowledge receipt of this filing on the enclosed copy of this letter and the Notice of Intent and return them to me. Thank you.

Very truly yours,

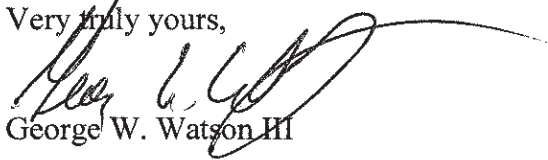

George W. Watson III

Enclosure

Copy to: Warwick City Council
Marie T. Ahlert, Warwick City Clerk
Peter D. Ruggiero, Esq., City Solicitor
Bess Gorman, Esq.
Christopher J. Novak, Esq.

13710701-v1

**STATE OF RHODE ISLAND AND PROVIDENCE PLANTATIONS
ENERGY FACILITY SITING BOARD**

In re: THE NARRAGANSETT ELECTRIC COMPANY
d/b/a NATIONAL GRID Notice of Intent to
Construct a Loop Line of Less Than 1,000 Feet
(Kilvert Street Substation Loop Line)

NOTICE OF INTENT TO CONSTRUCT

In accordance with Rule 1.6(c) of the Rhode Island Energy Facility Siting Board (“EFSB”) Rules of Practice and Procedure, The Narragansett Electric Company d/b/a National Grid (“TNEC”) hereby notifies the EFSB of TNEC’s intent to construct a 115kV tap line of approximately 80 feet in length in Warwick, Rhode Island (“Project”). The Project is required to serve a new 115/12.47 kV transformer being installed at the existing Kilvert Street #87 Substation (the “Substation”) located at 351 Kilvert Street, Warwick, Rhode Island (Warwick Assessor’s Map 278, Lot 3) (the “Property”). TNEC is the fee owner of the Property. In addition to the Substation, there is an existing transmission line right of way (“ROW”) on the Property where the I-187 and J-188 115 kV Transmission Lines (“I-187 and J-188 Lines”) are located. The new transformer will provide load relief to the area’s highly utilized distribution system and address normal and contingency loading issues in the Cranston and Warwick areas. The Project also includes the replacement of Structure 38-1 (a wood H-frame deadend structure) on the J-188 Line with a new 60 foot tall steel H-frame deadend switch structure.

TNEC files this notice pursuant to EFSB Rule 1.6(c) regarding new power lines of less than 1,000 feet with a capacity of 69 kV or more. According to the EFSB’s rules, the EFSB shall act upon this Notice, and any objection filed thereto, no later than forty-five days following the filing of this Notice. The Project does not constitute an “alteration” of a major energy facility because the length of the new tap line is less than 1,000 feet. See Rule 1.2(d).

1. Identification of the Owner of the Facility

The owner of the relevant facilities is TNEC, a subsidiary of National Grid USA, Inc., with a business address of 280 Melrose Street, Providence, Rhode Island 02907. The Substation and the existing ROW are located on the Property which is owned in fee by TNEC. The ROW is presently occupied by the I-187 and the J-188 Lines.

2. Detailed Description of the Proposed Facility

A. Length

The Project involves the construction of a new tap line that will be approximately 80 feet in length and connect the J-188 Line to the new transformer at the Substation. The new tap line structure will be installed near structure 37-B of the J-188 Line between the I-187 and the J-188 Lines.

B. Route

The new tap line will be supported by one approximately 40-foot tall wood H-frame terminal deadend structure for the tap line between structures 37 and 37-B of the J-188 Line. TNEC will also replace structure 38-1 with an approximately 60-foot tall steel H-frame deadend switch structure. Attached hereto as Exhibit A is the site plan for the Substation showing the proposed tap line. As shown on the site plan, the tap line will be parallel to the existing tap line that feeds the Substation's transformer.

C. Function

The primary driver for the new transformer is to address normal and contingency distribution feeder loading issues and Substation transformer contingency issues occurring in the area of T.F. Green Airport. The Substation transformer contingency is projected to be an issue under the forecasted load in the next five years. The new transformer will address this problem

and is consistent with the longer term plan for this area to supply load growth in and around T.F. Green Airport.

The conceptual cost estimate for the new tap line, transformer and related improvements is \$4.25M with a $\pm 25\%$ tolerance.

3. The Project Does Not Constitute a Major Energy Facility
Nor the Alteration of a Major Energy Facility

The Project does not constitute an “alteration” of a major energy facility. The proposed new tap line will be approximately 80 feet in length and the EFSB has expressly excluded power lines under 1,000 feet in length from the definition of “alteration” in Rule 1.2(d): “The construction, modification or relocation of a power line of 69 kV or more which are less than 1,000 feet in length shall not be treated as an alteration...” As noted above, the work will occur entirely within the TNEC fee-owned property that is already occupied by transmission lines, structures, and the Substation. The Board approved the existing tap line to the Substation in 2004. See *In re* The Narragansett Electric Company, Notice of Intent to Construct A Tap Line Less Than 1,000 Feet (Kilvert Street Substation Tap), EFSB Order No. 52 (decision dated March 19, 2004).

CONCLUSION

For the reasons stated above, TNEC respectfully requests that the EFSB enter an Order pursuant to EFSB Rule 1.6(e), accepting this Notice of Intent to Construct the new 115 kV tap line and ruling that the Project may proceed without any further review by the EFSB.

Respectfully submitted,

THE NARRAGANSETT ELECTRIC COMPANY
d/b/a NATIONAL GRID

By: 
Michael F. Ryan
280 Melrose Street
Providence, RI 02907

By its Attorneys,

Peter V. Lacouture
George W. Watson, III
Robinson & Cole LLP
One Financial Plaza
Suite 1430
Providence, RI 02903
(401) 709-3314
placouture@rc.com



Bess Gorman, Assistant General Counsel (RI Bar #8751)
National Grid USA Service Company, Inc.
40 Sylvan Road
Waltham, MA 02451
Tel. 781-907-1834 · Fax 781-907-5701
bess.gorman@nationalgrid.com

EXHIBIT A

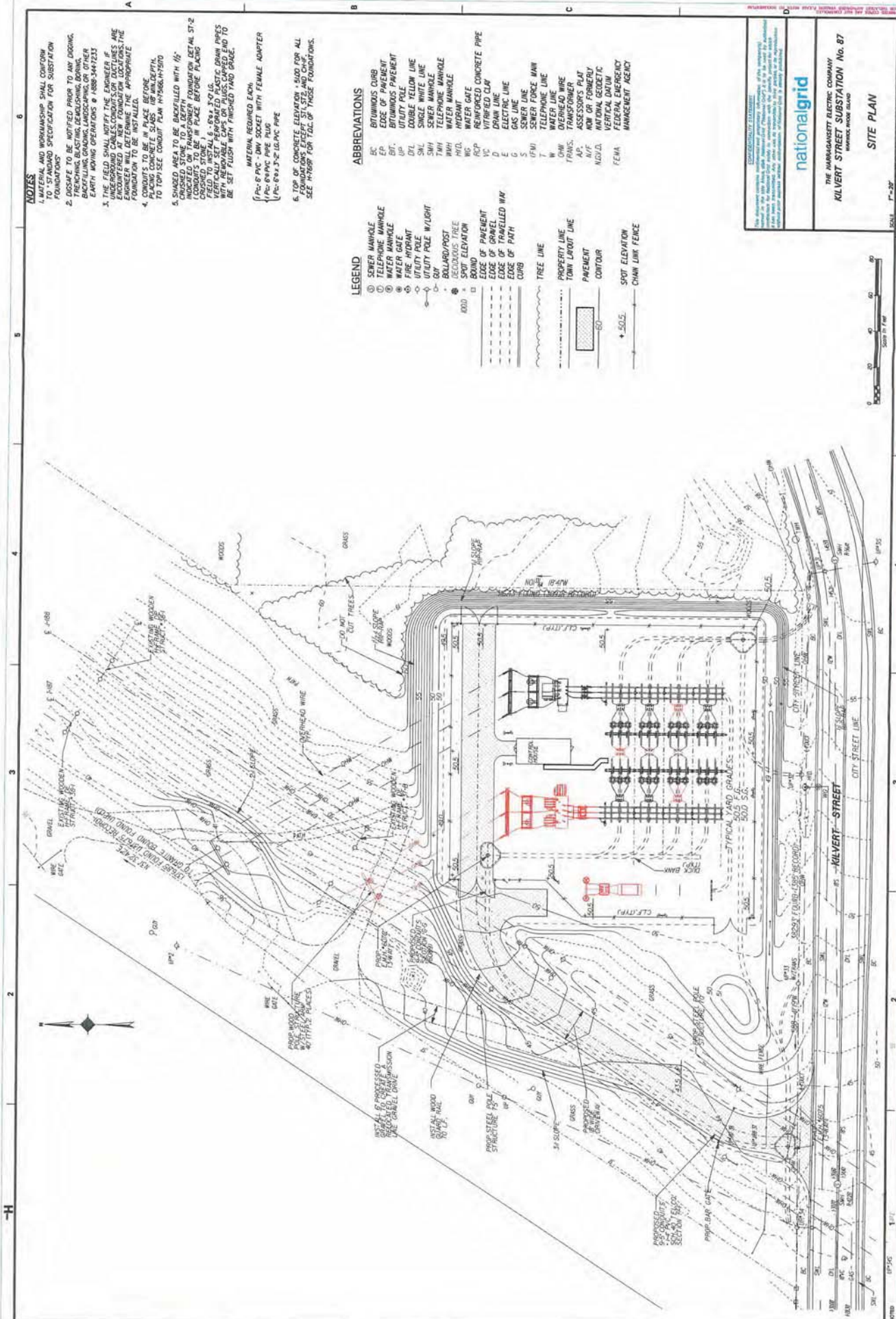

NOTES

1. MATERIAL AND WORKMANSHIP SHALL CONFORM TO STANDARD SPECIFICATION FOR SUBSTATION FOUNDATIONS.
2. DISSAFE TO BE NOTIFIED PRIOR TO ANY DIGGING, EXCAVATION, OR REMOVAL OF EXISTING UTILITIES OR EARTH MOVING OPERATIONS @ 1-800-344-1233.
3. THE FIELD SHALL NOTIFY THE ENGINEER IF UNDERGROUND CABLES, CONDUITS, OR DUCT LINES ARE DISCOVERED. THE ENGINEER WILL DETERMINE THE APPROPRIATE FOUNDATION TO BE INSTALLED.
4. CONDUITS TO BE IN PLACE BEFORE FOUNDATION TO BE INSTALLED.
5. SLOPED AREA TO BE DISCELTED WITH 1/2" CRUSSED STONE TO A DEPTH INDICATED ON TRANSFORMER FOUNDATION DETAIL ST-2 CRUSSED STONE TO BE IN PLACE BEFORE PLACING CONCRETE.
6. TOP OF CONCRETE ELEVATION SHALL BE AS SHOWN ON FOUNDATIONS EXCEPT ST-1, ST-2, AND ST-3. SEE H-7689 FOR TAIL OF THOSE FOUNDATIONS.

MATERIAL REQUIRED EACH:
 (1) 6" PVC - DW SOCKET WITH FEMALE ADAPTER
 (1) 6" PVC - DW SOCKET WITH FEMALE ADAPTER
 (1) 6" PVC - DW SOCKET WITH FEMALE ADAPTER

6. TOP OF CONCRETE ELEVATION SHALL BE AS SHOWN ON FOUNDATIONS EXCEPT ST-1, ST-2, AND ST-3. SEE H-7689 FOR TAIL OF THOSE FOUNDATIONS.

LEGEND

- ① SEWER MANHOLE
- ② TELEPHONE MANHOLE
- ③ WATER MANHOLE
- ④ WATER GATE
- ⑤ FIRE HYDRANT
- ⑥ UTILITY POLE
- ⑦ UTILITY POLE W/LIGHT
- ⑧ BALLAD/POST
- ⑨ DECIDUOUS TREE
- ⑩ BOUND
- ⑪ SPOT ELEVATION
- ⑫ EDGE OF PAVEMENT
- ⑬ EDGE OF TRAVELLED WAY
- ⑭ CURB
- ⑮ TREE LINE
- ⑯ PROPERTY LINE
- ⑰ TOWN LOT/LOT LINE
- ⑱ PAVEMENT
- ⑲ CONTOUR
- ⑳ SPOT ELEVATION
- ㉑ CHAIN LINK FENCE

ABBREVIATIONS

- EC BITUMINOUS COBB
- EP BITUMINOUS PAVEMENT
- UP UTILITY POLE
- DPL DOUBLE YELLOW LINE
- SML SINGLE WHITE LINE
- TMH TELEPHONE MANHOLE
- WMH WATER MANHOLE
- WS WATER GATE
- RCP REINFORCED CONCRETE PIPE
- VC VITRIFIED CLAY
- D DRAIN LINE
- E ELECTRIC LINE
- S SEWER LINE
- (FM) SEWER FORCE MAIN
- T TELEPHONE LINE
- W WATER LINE
- DW DIEHEAD WIRE
- INS. INSULATION
- ASB ASSURANCE SURVEY
- AVF AVE. OR FORMERLY
- NOVA. NATIONAL GEOGRAPHIC
- VD. VERTICAL DATUM
- FEMA FEDERAL EMERGENCY MANAGEMENT AGENCY

nationalgrid

THE HARGREAVES ELECTRIC COMPANY
 KILVERT STREET SUBSTATION No. 87
 WARRICK, INDIANA

SITE PLAN

SK-C-H-04142014

NO.	DATE	REVISIONS
1		
2		
3		
4		
5		
6		
7		
8		
9		
10		